

## RF Coaxial Surge Protectors MPSS0-3500-NF

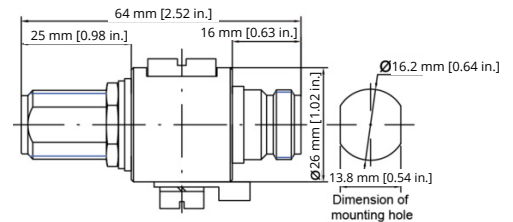

### Features and Benefits

- 4 GHz Bidirectional Coaxial Surge Protector
- High Energy GDT Technology
- Low Insertion Loss
- Field Replaceable GDT
- Waterproof Design
- DC Pass
- UL497E Listed



### Electrical Specifications

Impedance (Ohms)	50
Impulse Current 2 x 10/350µs Test - D1 Category (kA)	1
Nominal Discharge Current C2 Category (dB)	≥20
Max Power (W)	25
DC Pass	Yes
Insulation Resistance (Ohms)	≥10
RF SPD Type	UL497E Listed
Volts (V)	48
AC/DC/DC PV/RF	RF
Line Current Max (A)	10
Ambient Min (C)	-50
Ambient Max (C)	+85
IMAX8/20µs (kA)	20
Frequency Range (GHz)	0-4.0
Insertion Loss (@ Freq) (dB)	<0.2
Return Loss (dB)	=>20
VSWR	<1.20:1



Enduring Quality, Exceptional Value

[www.marathonbroadband.com](http://www.marathonbroadband.com)

### Mechanical Characteristics

Contacts	Bronze/Surface Au-Ag
Insulation Material	PTFE
Technology	GDT
Connection Method	Series N-Type Connector-Female-Female
Mounting Bulkhead, Optional	BRACKET
Material	Cu, Zn, Sn plated Brass, PTFE
IP Rating	IP67
Dimensions	See diagram
Weight (lbs./kg)	.3/.136

### Standards

UL Standard	UL497E
UL Category	QVLA
UL File Number	E537205
Standards	NOM-003-SCFI-2014, NOM-001-SCFI-1993
Environmental Standards	RoHS